

Mini Brass Ball Valve

KAS®



TECHNICAL DATA SHEET

Product Name	Mini Brass Ball Valve
Working Temperature	-10°C/+100°C
Working Pressure	10 bar
Intended Use	Air / Water Installation

MATERIAL SPECT

Body	BRASS (CW617N) TS EN 12165
Ball Seal	PTFE (TEFLON)
Stem	BRASS (CW614N) TS EN 12164
Stem Seal	NBR (ORING)
Ball	BRASS (CW617N) TS EN 12165
Handle	PLASTIC

SURFACES FINISH

Body	NICKEL
Stem	
Ball	NICKEL + CHROME
Handle	Different color options

DIMENSIONS

Code	DN	D1	D2	AA	L	H	H1	L1
05.03.322	15	1/2"	1/2"	25	43	32	12,5	32

Dimensions are in "milimeter"

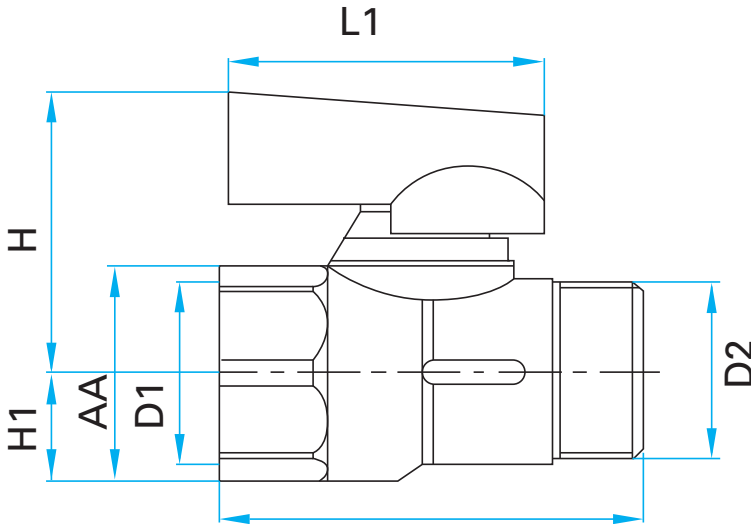

INSTALLATION INSTRUCTION

- 1- Do not unpack the valve until installation to prevent falling of any unwanted substance that may affect the working of valve.
- 2- Take measures against any possible damage that may occur during transport and shipment.
- 3- Clean away every unwanted substance in your system before installation.
- 4- Valve should be off position while installing.
- 5- Be careful that the thread length of the part that will be installed to the valve will not be too longer or too shorter than the thread length of the valve.
- 6- While installing, grab the valve by the appropriate tool from the across flats where you'll install it.
- 7- During installation do not use excessive adhesive or any unsuitable substance.
- 8- Use the valve fully open or fully closed position.
- 9- Do not paint the valve. Do not expose the valve with abrasive chemicals.
- 10- Do not use any other tools for opening or closing the valve and do not remove the handle.
- 11- In case of any damage or disorder , valve should be changed by authorities.
- 12- Complying with the installation and usage instruction is compulsory. Otherwise, the product will be out of guarantee.
- 13- Do not forget to get the document of guarantee. This document is valid only with the related bill.